

- * DOWEL INTO EXISTING CONCRETE
- * CUT & PIER EXISTING SLAB X 1
- * SHEDLINER ROOF INSULATION
- * 2 X WHIRLY BIRDS
- * ROLL TOP RIDGE
- * FFL +100 ON EXISTING SHED
- * ATTACH TO EXISTING SHED

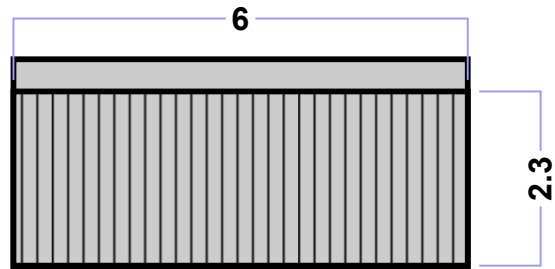

LEFT ELEVATION

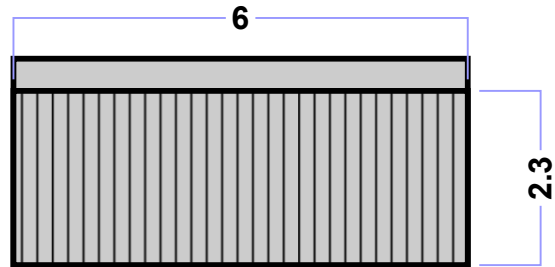

RIGHT ELEVATION

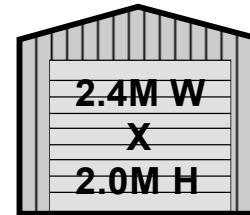

FRONT ELEVATION

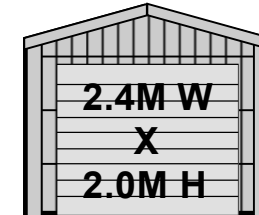

REAR ELEVATION

Site:	2A BYRAN STREET, OLD BAR, NSW, 2430	Drawing: 001	Project: QUOTE STAGE	Drawn: ADAM GATEHOUSE	Notes: TO SHOW PROPOSED SHED TO BE ATTACHED TO EXISTING	MIDCOAST SHEDS 147A MANNING RIVER DIRVE, TAREE SOUTH NSW, 2430 (02) 6551 4473 WWW.MIDCOASTSHEDS.COM.AU ADMIN@MIDCOASTSHEDS.COM.AU
Title :	OLD BAR COMMUNITY PRE-SCHOOL	Scale: 1:100	Date: 13/09/2024	Rev: A		